

ALSB85CH | ALSB85S | ALSB85BL

*LUXURY LANDSCAPE BOLLARD 8
INSTALLATION MANUAL*





TABLE OF CONTENTS

1. Introduction	1
2. Specifications	2
3A. Model Details	2
3B. Model Dimensions	3
4A. What's Included	3
4B. Recommended Tools	3
5. System Planning & Precautions	4
6. Recommended Burial Depth	6
7. Optional Drain Plug	6
8. Recommended Burial Wire	8
9. Tap Setting Location	8
10A. 70V/100V vs LoZ Wiring Guidance	9
11A. 70V/100V Wiring Diagram	11
11B. 70V & LoZ Wiring Diagram	12
12. Note: Painting the Sleeve	13
13. Troubleshooting	14
14. Technical Assistance	15
15. Limited 5 Year Warranty	16
16. Return Process	17

1. INTRODUCTION

Congratulations on selecting the Luxury Landscape Bollard 8, one of the finest outdoor speaker systems ever produced, and the medium sized speaker within our Ambisonic Bollard Collection.

At Ambisonic, we take pride in providing you with a high quality product, all speakers are designed to have excellent sound quality, longevity, and a simple installation process.

Our Landscape Bollard 8 is a revolutionary unit composed of both a subwoofer and a mid/high frequency satellite. The speaker is designed to allow the subwoofer section to be buried in the ground leaving only the pillar section exposed. The sound from both the subwoofer & satellite emanate from the slots through the upper portion of the pillar section creating a uniform, full frequency sonic experience.

This instruction booklet covers the necessary information for a smooth installation. It includes the tool list you will need, step-by-step instructions for installation, troubleshooting tips for any errors that may occur, and all warranty information.

If for any reason you experience problems or if you have installation questions please call us at (844) 674-4461. Hours of operation are 8:00am to 5:00pm (Pacific Time), Monday through Friday.

Scan the QR Code for full instructions for this product.



2. SPECIFICATIONS

MODEL	ALSB85CH • ALSB85S • ALSB85BL
COLOR	Champagne • Stargazing Silver • Midnight Black
Woofer	8" (203mm) Polypropylene Woofer
Midrange	5 ¼" (133mm) Polypropylene Midrange
Tweeter	1" (25mm) HD Aluminum Conical Ribbon Tweeter
Frequency Response	48HZ - 20KHZ
Power RMS	100W 50W
Power	200W 100W (Program) 400W 200W (Peak)
Impedance	6 Ω (Sub) / 6 Ω (Sat)
Transformer Taps	Selectable LoZ, or 70V: 100W Subwoofer 50W Midrange 100V: 100W Subwoofer 50W Midrange
Enclosure Material	Poly Composite, Weather Resistant Enclosure

3A. MODEL DETAILS



Sleeve Shape	Sleeve Shape	Sleeve Color	Sound Dispersion
ALSB85CH	Hexagonal	Champagne	360°
ALSB85S	Hexagonal	Stargazing Silver	360°
ALSB85BL	Hexagonal	Midnight Black	360°

*All product specifications are subject to change. Please refer to ambisonicsystems.com for latest information.

3B. MODEL DIMENSIONS

MODEL	ALSB85CH • ALSB85S • ALSB85BL
Subwoofer Enclosure	Ø 15 ¾" (400mm) • 9 ⅙" (230mm) Depth
Sleeve Dimensions	7 ⅞" x 6 ⅙" (188 x 176mm) Hexagonal Widths
	22" (558mm) Height (includes 5mm sleeve base)
Total Height	31 ⅙" (788mm)

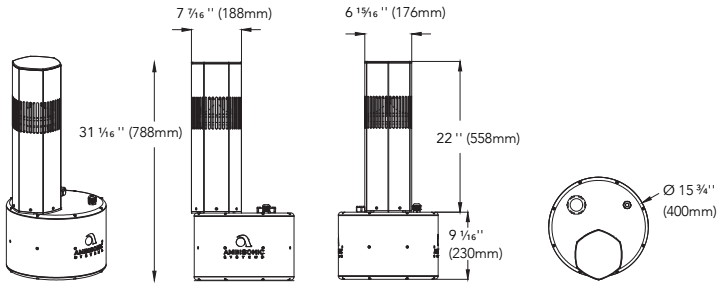

Orthographic View

• Side Views x 2

• Overhead View

4A. WHAT'S INCLUDED

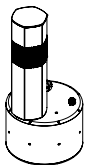

Speaker



Wire Nuts (4)



Start Guide

4B. RECOMMENDED TOOLS

- Direct Burial Wire
- Speaker Wire
- Shovel
- Screwdrivers
- Wire Stripper
- Measuring Tape

5. SYSTEM PLANNING & PRECAUTIONS

5A. SYSTEM PLANNING: SOUND QUALITY

The Landscape Bollards should be strategically placed to evenly distribute sound throughout the outdoor area.

Placement throughout the exterior will also depend on a couple of factors:

UNIFORMITY OF SOUND REQUIRED: The laws of physics dictate that the further the listener is from the sound source the lower the apparent sound pressure level or “volume.” Because of this there will always be areas with less sound and others with more. A greater number of speakers in the system will always make for more even coverage.

SOUND PRESSURE REQUIRED: Some systems are designed for background or ambient music only, while others are designed to rock the house or provide dance music. Again, the number of speakers will affect the maximum output. You may consider creating different zones, where louder music is required in one area and softer music in others.

If you are concerned about determining speaker placement, a free design service to help you map the optimal speaker placements as well as recommended amplifier power and project scale.

Email: sales@originacoustics.com for more information.

5B. SYSTEM PLANNING: PRECAUTIONS

Once coverage and sound pressure requirements have been determined, the Bollard locations can be selected. Before digging, confirm there are **NO** subterranean obstructions such as water or gas lines, sprinkler pipes or electrical conduits.

5C. SYSTEM PLANNING: SPRINKLER PRECAUTIONS

It is highly recommended that the speakers be installed at a location such that the water sprinkler nearby (if any) does **NOT** spray the water jet **INTO** or **+/- 2 INCHES FROM** vertical slots of the bollard shell. Fully plan out the locations of all buried subwoofers and wires before beginning the installation process.

FOLLOW THE ILLUSTRATIONS BELOW:

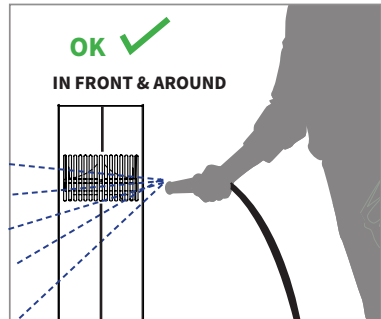
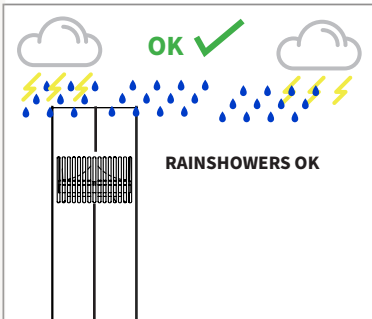
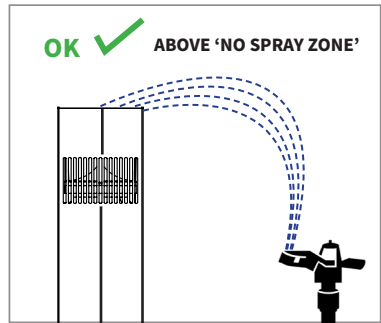
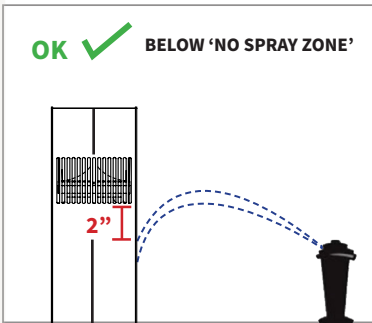
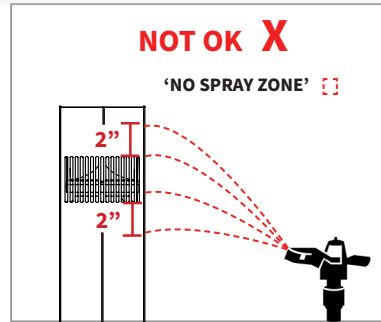
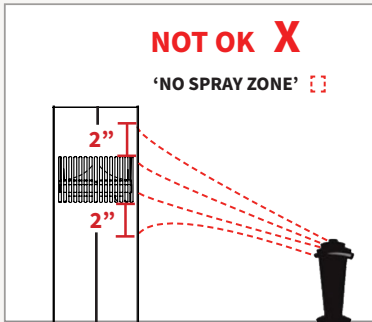

6. RECOMMENDED BURIAL DEPTH

The subwoofer enclosure should be buried to a level where the dirt covers the wire nut and protruding wire at the top of enclosure. Holes for the subs should be deep enough to cover the entire lower section of the enclosure with approximately 1-inch of dirt on top of the that section. This will allow the pillar (shell) to protrude about 18-inches above the surface. Do not bury excessively deep. Care should be taken to ensure that all bollards extend to the same height above ground.

7. OPTIONAL DRAIN PLUG



The Ambisonic Bollard loudspeaker comes with a drain plug inserted at the bottom of its subwoofer enclosure. If there is water ingress for any unavoidable reason, removing the drain plug will allow for water to drain out. The drain plug is easily removable with a utility knife.

7A. OPTION 1: WITH DRAIN PLUG

DRAIN PLUG REMAINS IN THE SUB ENCLOSURE

This option is recommended:

- In applications where ground water is at shallow depths and expected to rise easily above ground level or areas with overall very wet soil.
e.g. Areas of Houston, Louisiana

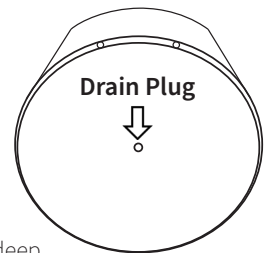

For Bollard with drain plug inserted:

1. Dig a hole for the subwoofer, about 21" in diameter and 19" deep.
2. Place the subwoofer as level as possible and not tilted.
3. Take care to fill empty spaces around drain hole where water might accumulate.
4. The subwoofer shouldn't be in contact with large rocks or large empty holes below the drain hole.
5. Use 2" of loose dirt to cover the top of subwoofer enclosure.

7B. OPTION 2: WITHOUT DRAIN PLUG

DRAIN PLUG IS REMOVED

This option is recommended:

- In applications with dry soil where occasional water may accidentally enter the enclosure. Use of gravel and sand will allow any water that gets into the sub enclosure to properly escape.

e.g. Las Vegas, Inland Southern California, Southwest desert

For bollard with drain plug removed:

1. Dig a hole for the subwoofer, about 21" in diameter and 19" deep.
2. Lay gravel rock (3/8" size recommended) for a depth of min. 3" below the bottom of subwoofer enclosure.
3. Place the subwoofer as level as possible and not tilted.
4. Take care to not block the drain hole by direct contact with gravel rock.
5. Use 2" depth of loose dirt to cover the top of subwoofer enclosure.

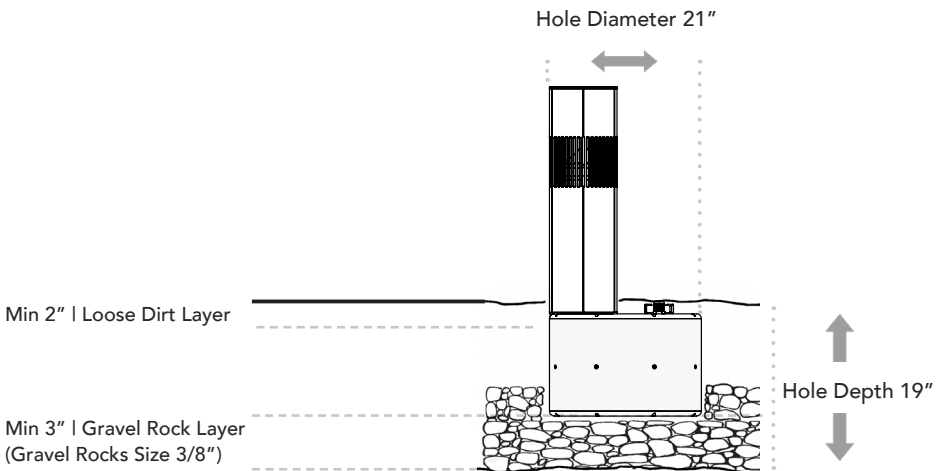

NOTE: DO NOT BURY THE ENCLOSURE UNTIL ALL WIRING HAS BEEN COMPLETED.

8. RECOMMENDED BURIAL WIRE

BURIAL INSTALLATION

Wire Length	Wire Gauge
0 - 100' (0 - 30m)	16
50 - 150' (15 - 45m)	14
Over 100' (30m)	12

9. TAP SETTING LOCATION

Each Bollard speaker comes with a wire pigtail connecting into the subwoofer and satellite units of Bollard speaker, and each wire pair is labeled as **SUB IN** and **SAT IN** respectively.

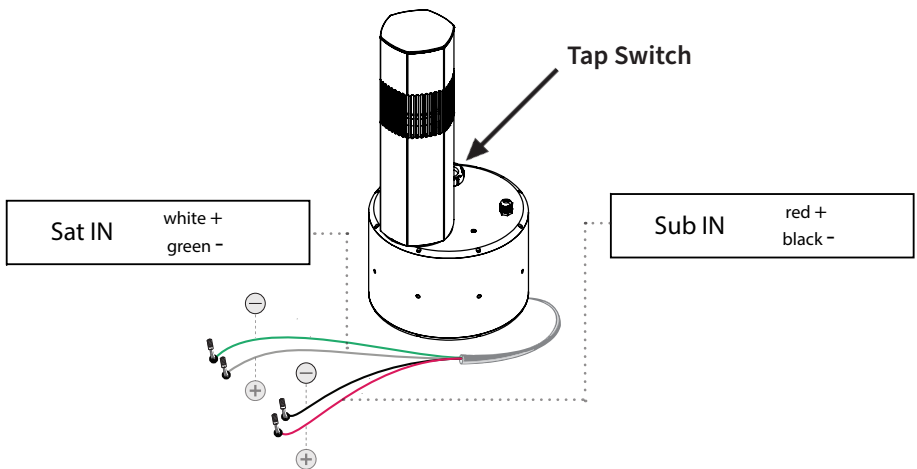

To change the power tap setting, use the tap switch under the cap on the subwoofer. Ensure this selection is done before assembly & subwoofer burial.

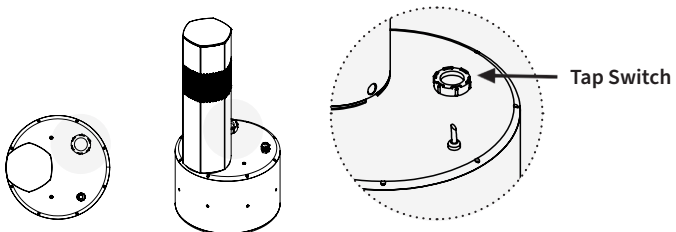

10A. 70V/100V VS LO-Z WIRING GUIDANCE

WE HIGHLY RECOMMEND WIRING IN 70V/100V WIRING AS THE CORRECT SOLUTION.

TAP SWITCH SETTING	RECOMMENDED AMP	MAX. NUMBER OF BOLLARD SPEAKERS
50 W (100V)	PROA250.2 Amp	TOTAL 4 PER PROA250.2 Amp (2 per Channel)
50 W (70V)	PROA250.2 Amp	TOTAL 4 PER PROA250.2 Amp (2 per Channel)
LoZ (bypass)	PROA250.2 Amp	TOTAL 2 PER PROA250.2 Amp (1 per Channel)

If you are looking to use more than 2 Bollard speakers, 70V/100V is the proper solution. In the LoZ tap switch position, the transformers are bypassed

* **WARNING: ONLY RUN A MAXIMUM OF 2 (TWO) BOLLARD SPEAKERS IN LO-Z TAP SWITCH SETTING.**

IMPORTANT: Although the bollard offers a LoZ (Ohm Ω) Tap Switch position, we highly recommend wiring in 70V/100V for your outdoor application. Due to the impedance in the LoZ (Sub) / LoZ (Sat) setting, the Transformers are bypassed, **ONLY 1 PAIR OF BOLLARDS CAN BE USED (1 PAIR PER CHANNEL) in LoZ.**

FOR THIS REASON, THE 70V WIRING IS HIGHLY RECOMMENDED TO ENSURE OPTIMAL SOUND QUALITY, REGARDLESS OF PLACEMENT DISTANCE OR NUMBER OF BOLLARDS DESIRED FOR YOUR SYSTEM.

- Use 1 SEPARATE wire run for: **SUBWOOFER units of Bollards**
- Use ANOTHER separate wire run for: **SATELLITE units of Bollards**
- The subwoofers and satellites will be run in **PARALLEL for 70V WIRING SETUP.**

10B. PARALLEL WIRING SETUP

This means the positive connection on the amplifier will be connected to the positive connection on speaker 1, 2, 3, etc. The negative connection will be connected to the negative connections on the speakers as well. This can be accomplished with a single pair of wires in a “daisy chain” where the amplifier is at one end and the speakers are connected consecutively.

- Alternatively, you can also wire in a star pattern where each speaker is directly wired back to the amplifier.

10C. MONO OR STEREO SETUP

- Consider whether you will be running the satellites in mono or stereo.

In many applications the listener will never be equidistant from a left and right speaker, so mono may be the best option. Regardless, the PROA250.2 offers four independent channels so either option is viable. Remember, if you will be running in stereo you will need to run four wires to each speaker, (+) and (-) for left or right, and sub.

PLEASE CONTACT OUR CUSTOMER SERVICE FOR ANY INQUIRY REGARDING THE SETUP.

11A. 4 x BOLLARDS: (50W) 70V/100V WIRING WITH PROA250.2

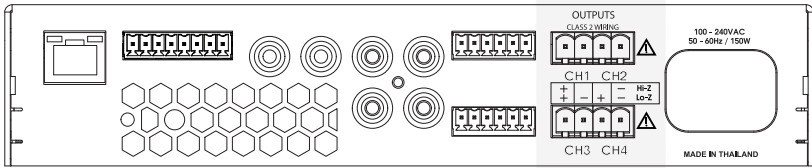

Amp Output mode set to Hi-Z -70V/100V [Bridge mode]

- OUTPUT CH1/CH2 for Satellites
- OUTPUT CH3/CH4 for Subwoofers

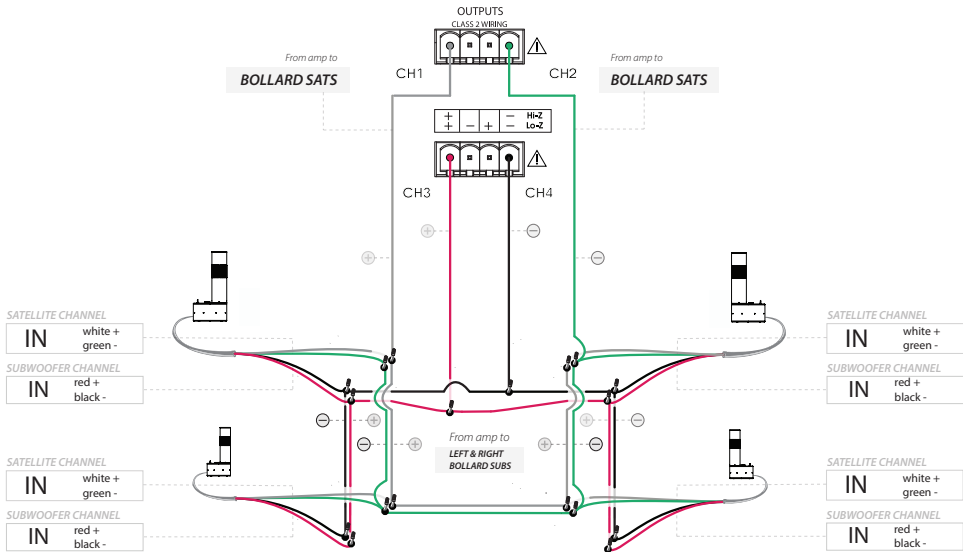

2 CHANNEL SETUP

MAXIMUM NUMBER OF BOLLARDS PER AMP: 4 BOLLARDS
(50W TAP SETTING)

11B. 2 X BOLLARDS LO-Z WIRING WITH PROA250.2

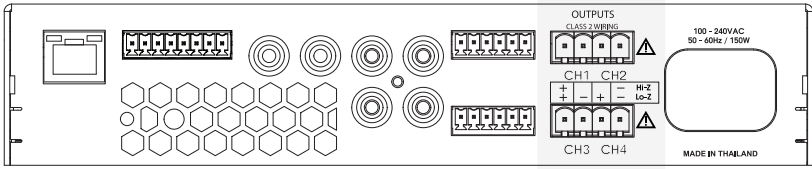

Amp Output mode set to Lo-Z [4~8 ohms]

- OUTPUT CH1 & CH2 for Satallite
- OUTPUT CH3 & CH4 for Subwoofer

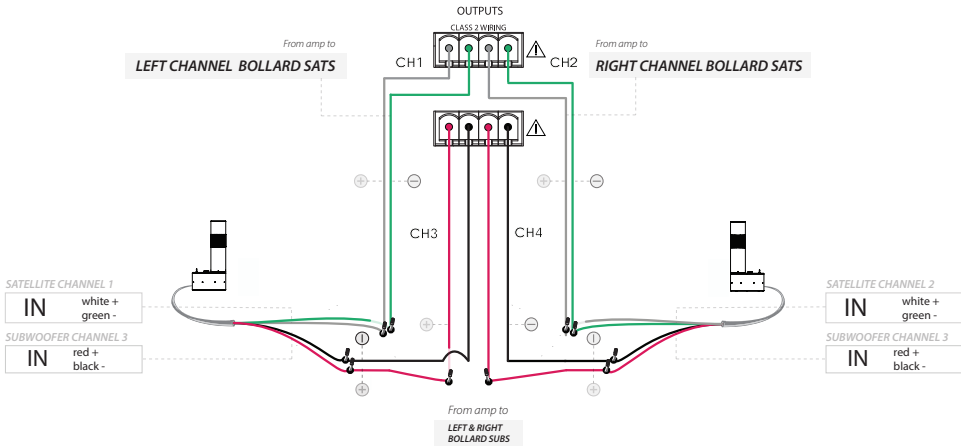

* WARNING:

ONLY Run maximum 2 (TWO) Bollard speakers per Amplifier in LoZ Tap switch setting.

4 CHANNEL SETUP

MAXIMUM NUMBER OF BOLLARDS PER AMP: 2 BOLLARDS
(LO-Z TAP SETTING)

12. NOTE: PAINTING THE SLEEVE

The outer sleeve (pillar) of the Ambisonic Bollard speaker has been anodized specifically for achieving maximum durability of the pillar color. If you wish to change the color of the Landscape Bollard sleeve by painting, or other process, it may compromise the durability and finish of the product, compared to the original manufacturing process and modify the specifications.

Please refer to the Warranty section, as choosing to modify the shell/sleeve may invalidate the Warranty.

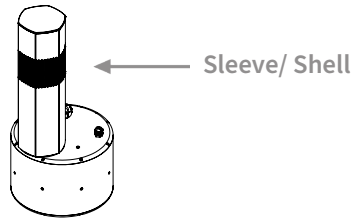

13. TROUBLESHOOTING

If you have a problem, try isolating it first. For example, if you're playing a DVD and there is no sound, try replacing the DVD with an MP3 player to see if you get sound. If it does work, then the problem is with the television, DVD player, or the cables connecting them. If it doesn't work, the problem will be with the amplifier, speakers, or those cables.

Problem	Possible Cause
No Sound	The volume may be turned down or muted. Check the volume settings on both the amplifier and the DVD player/television/computer/etc.
No Sound	Make sure the proper source is selected on the amplifier or receiver.
No Sound	Check the cord connecting the amplifier with the source. The cord may be damaged or plugged into the wrong input or output.
No Sound	Check the wires connecting the amplifier with the speakers. Make sure they're connected properly and not damaged in any way.
No Sound	Check the ProA Gain levels using the Origin PRO Web App/ GUI
No Sound	Check the ProA Input routing using the Origin PRO Web App/ GUI
Poor Sound Quality	If you hear something like static, or the sound is cutting in and out, check the audio cables. If the problem increases when a cable is being moved, then the cable is most likely faulty or not connected properly.
Poor Sound Quality	Today's audio systems may have several places to adjust the volume, for example your MP3 player may have a volume control, and your amplifier may also have one. Check to be certain that the volume isn't turned up past 80% on any device.
Poor Sound Quality	Try changing sources to be certain that the selection you've chosen is a good quality recording.

14. TECHNICAL ASSISTANCE

If you have any questions or concerns about installing or using this product, you can reach us through one of the following methods:

Phone: (844) 674 - 4461

Hours of operation: 8:00am - 5:00pm (Pacific Time), Mon - Fri

Email: sales@originacoustics.com

If you are having technical trouble, please include the model number and briefly explain what steps you took to resolve the problem in your email, or be prepared to answer these questions over the phone. If you are considering returning the product, it's required that you contact Ambisonic prior to any return attempts. This way we can determine if the issue can be resolved without returning the product, or if needed we can provide instructions and support for the return process.

15. LIMITED 5 YEAR WARRANTY

Ambisonic warrants to the original retail purchaser only that this Ambisonic product will be free from defects in materials and workmanship, provided the speaker was purchased from an Ambisonic authorized dealer.

If the product is determined to be defective, it will be repaired or replaced at Ambisonic's discretion. If the product must be replaced yet it is no longer manufactured, it will be replaced with a model of equal to or greater value that is the most similar to the original. If this is the case, installing the replacement model may require mounting modifications; Ambisonic will not be responsible for any such related costs.

15A. REQUIREMENTS & WARRANTY COVERAGE

This warranty may not be valid if the product was purchased through an unauthorized dealer. This warranty only applies to the individual that made the original purchase, and it cannot be applied to other purchases. The purchaser must be prepared to provide proof of purchase (receipt). This warranty will not be valid if the identifying number or serial number has been removed, defaced, or altered.

**All warranties and warranty conditions are subject to change.*

Please refer to www.ambisonicsystems.com for the latest information.

15B. NOT COVERED BY WARRANTY

- Accidental damage
- Damage caused by abuse or misuse
- Damage caused by attempted repairs/modifications by anyone other than Ambisonic or an authorized dealer
- Damage caused by improper installation
- Normal wear, maintenance, and environmental issues
- Damage caused by voltage inputs in excess of the rated maximum of the unit
- Damage inflicted during the return shipment
- Performance issues caused by modifications. ie: painting of the shell.

16. RETURN PROCESS

Before making any return attempts, it is required that you first contact Ambisonic customer support team. Return product to Ambisonic or your dealer, either in person or by mail. It's preferable if the product is returned in the original packaging. If this isn't possible, the customer is responsible for insuring the shipment for the full value of the product.

This warranty is in lieu of all other expressed or implied warranties. Some states do not allow limitations on implied warranties, so this may not apply depending on the customer's location. (For more information, see Magnuson-Moss Warranty Act.)



06-26-24

6975 S Decatur Blvd, Las Vegas, NV 89118 • www.ambisonicsystems.com • 844-674-4461

©2024 Ambisonic. All copyrighted, trademarked and patented elements mentioned herein are the sole property of Ambisonic Systems.