



12HDR-AW



Composite Woofer



Neodymium Motor

## 12HDR-AW-70V | 12HDR-AW-8OHM

### Description

The 12HDR-AW is an all-weather high definition compact subwoofer, featuring a high power 12" long throw low frequency transducer. The 12HDR-AW Subwoofer delivers the punch, impact and clean tight bass necessary for hard surface installations. The perfect compliment to our 6.5HD Loudspeakers to deliver the ultimate in "High Definition" audio for any outdoor environment. Backyard landscapes, patio and pool areas will come alive with unparalleled clarity and detailed sound, engineered to give years of listening satisfaction and pleasure. The dual ported composite enclosure, as well as all stainless-steel hardware components, are designed to withstand the harshest of environmental conditions in any permanent outdoor installation.

Available in either 8 Ohm or 70 Volt, the 70 Volt version arrives with a high-performance, custom built 70 Volt | 300 Watt Toroidal Transformer, offering low distortion, minimal saturation, and linear response, for use when long wire runs or distributed audio is a requirement.

### Features

- 1 ● Cylindrical design to reduce standing waves.
- 2 ● All weather long throw woofer featuring the highest quality stiff composite cone and large half roll rubber surround.
- 3 ● Massive internal neodymium motor structure secured in a tuned, down firing enclosure.

Scan the QR Code for full instructions for this product.





## Feature Highlights

- 1 ● Powder Coated Grille
- 2 ● Wire Pigtail Input
- 3 ● Water Tight Strain Relief
- 4 ● Precision Tuned Dual Ports with Internal Mesh Grilles
- 5 ● All weather, robust, composite enclosure - rated IP-26 per IEC529.
- 6 ● Rubber feet included for skid/vibration free operation on hard surfaces.
- 7 ● 70V | 300W Custom Toroidal Transformer



## Specifications

SPECIFICATIONS	12HDR-AW-70V   12HDR-AW-80HM
System Type	Vented Alignment Subwoofer
Driver Components	All Weather 12" Long Throw Woofer
Crossover	Recommended HPF= 30Hz 12dB per octave Butterworth
Frequency Response	33Hz - 300Hz (-10dB)   41Hz - 300Hz (+/- 3dB)
Maximum SPL	123 dB Continuous, 129 dB Peak
Sensitivity, 2.83V @ 1m	93 dB
Power Handling	1000W AES, 2000W Max Power Handling, 4000W Peak
Rated Impedance	8 Ω  OR  70V 300W
Input Connectors	24" x 12AWG Pigtail with Waterproof Wire Nuts
Enclosure Material	Ported Composite
Dimensions (H x W)	Ø 18" x 18" H (Ø 45.7cm x 45.7cm)
Weight, Net / Shipping	54lbs (24.5kg) / 64 lbs (29kg)
Warranty	Limited 5 Year Warranty

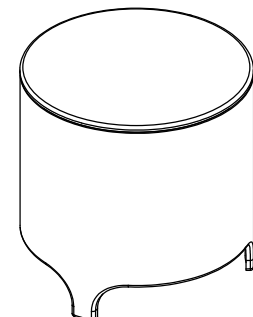
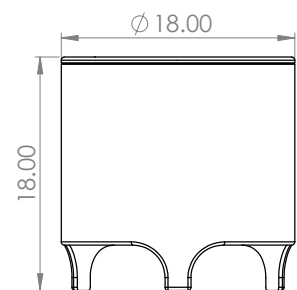

\*All product specifications are subject to change. Correct as of 06-21-23. Please refer to [ambisonicsystems.com](http://ambisonicsystems.com) for latest information.