



1.

10HDR-AW



2.

Composite Woofer



3.

Ferrite Motor

10HDR-AW-70V | 10HDR-AW-8OHM

Description

The 10HDR-AW is an all-weather high definition compact subwoofer, featuring a high power 10" long throw low frequency transducer. The ported composite enclosure as well as all components are designed to withstand the harshest of environmental conditions in any permanent outdoor installation.

The 10HDR-AW Subwoofer delivers the punch, impact and clean tight bass necessary for hardscape installations. The perfect compliment to our Immersive HD Loudspeakers, delivering the ultimate in "High Definition" audio for any outdoor environment. Backyard landscapes, patio and pool areas will come alive with unparalleled clarity and detailed sound, engineered to give you years of listening satisfaction and pleasure. Available in either 8 Ohm or 70 Volt, the 70 Volt version arrives with a high-performance, custom built 70 Volt | 300 Watt Toroidal Transformer, offering low distortion, minimal saturation, and linear response, for use when long wire runs or distributed audio is a requirement.

Features

- 1 ● Cylindrical design to reduce standing waves.
- 2 ● All weather long throw woofer featuring the highest quality stiff composite cone and large half roll rubber surround.
- 3 ● Massive internal ferrite motor structure secured in a tuned, down firing enclosure.

Scan the QR Code for full instructions for this product.





Feature Highlights

- 1 ● Powder Coated Grille
- 2 ● Wire Pigtail Input
- 3 ● Water Tight Strain Relief
- 4 ● Vented Port with internal mesh grille
- 5 ● All weather, robust, composite enclosure - rated IP-26 per IEC529.
- 6 ● Rubber feet included for skid/vibration free operation on hard surfaces
- 7 ● 70V | 300W Custom Toroidal Transformer



Specifications

SPECIFICATIONS	10HDR-AW-70V 10HDR-AW-80HM
System Type	Vented Alignment Subwoofer
Driver Components	All Weather 10" Long Throw Woofer
Crossover	Recommended HPF = 37Hz 12dB per octave Butterworth
Frequency Response	35Hz - 300Hz (-10dB) 50Hz - 300Hz +/- 3dB
Maximum SPL	118 dB Continuous, 124 dB Peak
Sensitivity, 2.83V @ 1m	93 dB
Power Handling	300W AES, 600W Max Power Handling, 1200W Peak
Rated Impedance	8 Ω OR 70V 300W
Input Connectors	24" x 12AWG Pigtail with Waterproof Wire Nuts
Enclosure Material	Ported Composite
Dimensions (Dia x Depth)	Ø 12.75" x 16.5" H (Ø 32.4cm x 41.9cm)
Weight, Net / Shipping	35lbs (15.4kg) / 39lbs (17.6kg)
Warranty	Limited 5 Year Warranty

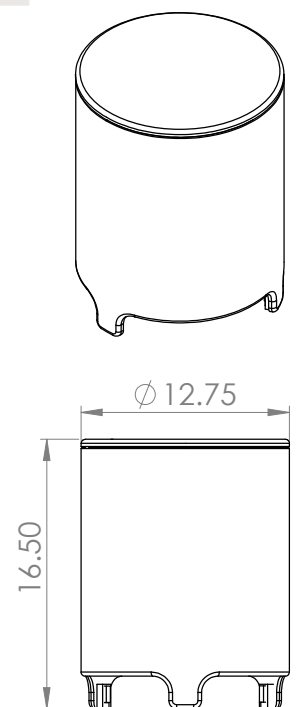

*All product specifications are subject to change. Correct as of 06-21-23. Please refer to ambisonicsystems.com for latest information.